

SOCE012-80/100CM Installation Instruction

1. Product accessories and quantity (it is recommended to put more spare screws)

			
4*40 self-tapping screws	3.5*12 self-tapping screw	tipping gear	Three-layer plastic tipping bucket hinge
B4*34 (2 spares included)	A1*14 (including 2 spares)	S15*2	P9*1
			
spring shelf pin	Boxer hinge	3.5*14 self-tapping screw	
L8*2	F0*2	A2*16 (including 2 spares)	
			
Eccentric rod + eccentric wheel		screwdriver	
DO*2 (includes a spare)		1	

Kind tips:

1. Please refer to the drawings to distinguish the boards during installation.

The color of the product is not subject to the instructions;

2. Tighten the screws seven times, and then tighten them after everything

is completed! 3. Some plates have red faces, and the red faces are facing down or inward.

4. Please read all the drawings before installation

5. If there are extra screw accessories, they are spare screws given by the manufacturer!

2. Installation steps of eccentric parts

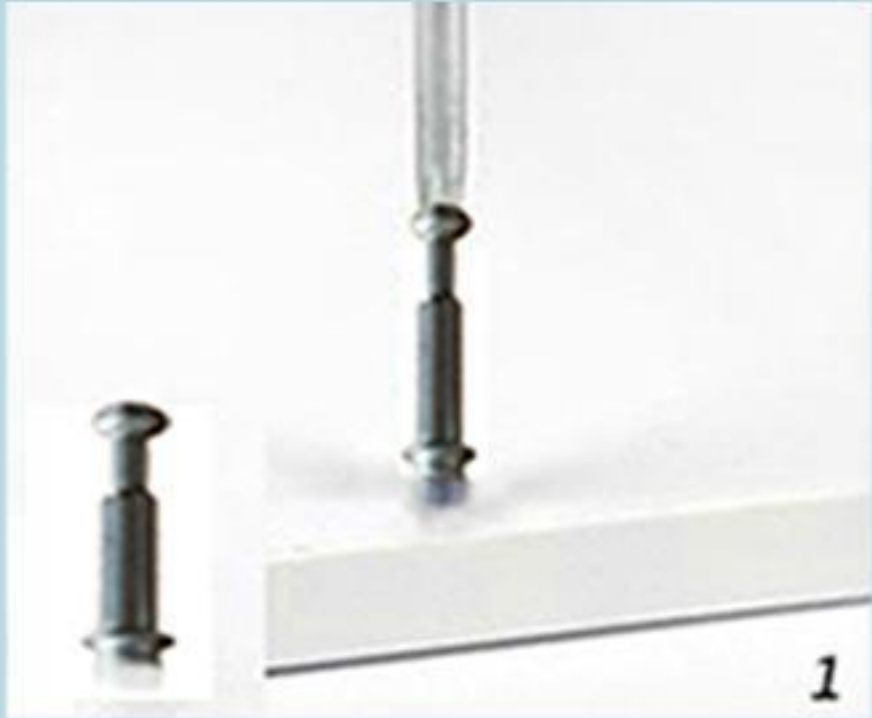

Screw the eccentric rod to the plate



Find the corresponding board to insert



find the hole



Insert the eccentric wheel into the round

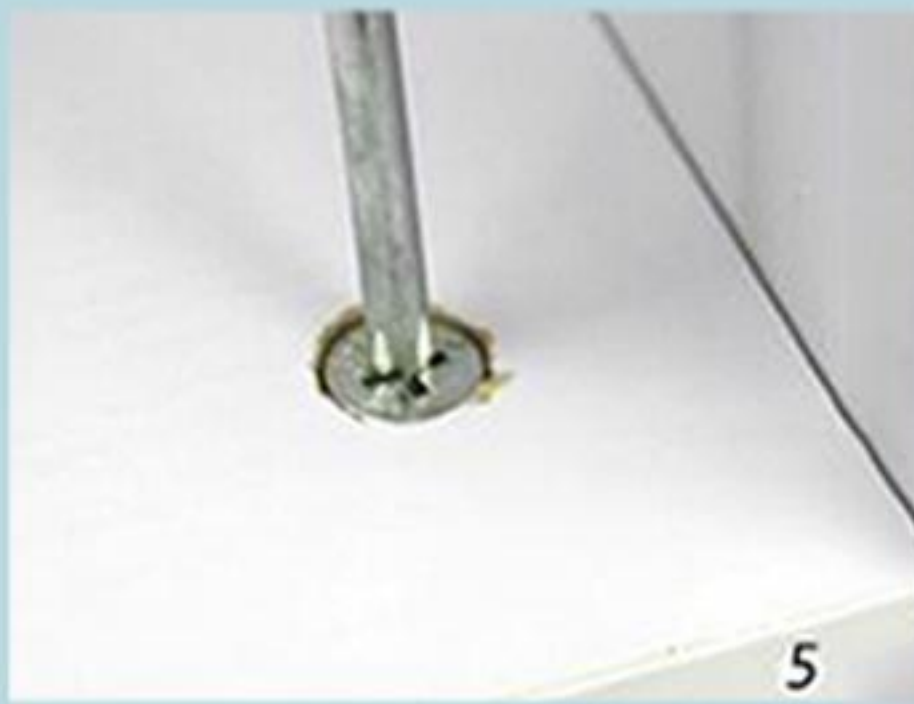

Rotate 180° clockwise

Lock the board left and right



hole 3. Hinge installation steps:

The door gap is too large



As shown in the picture, the screw pointed by the screwdriver is used to adjust the gap of the cabinet door, and the clockwise rotation is to adjust the gap of the door panel to become smaller.

The gap between the door panel and the side panel is too large



As shown in the picture, the screw pointed by the screwdriver is used to adjust the front and rear position of the door panel. First loosen the screw counterclockwise, then adjust the position of the door panel back and forth. After the position adjustment is completed, tighten the screw clockwise.

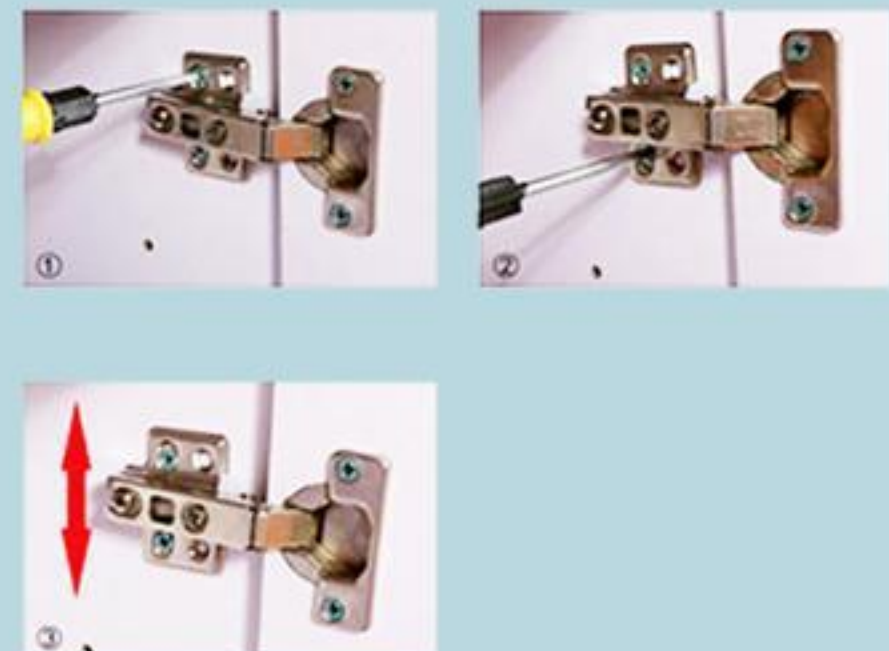

uneven door panels

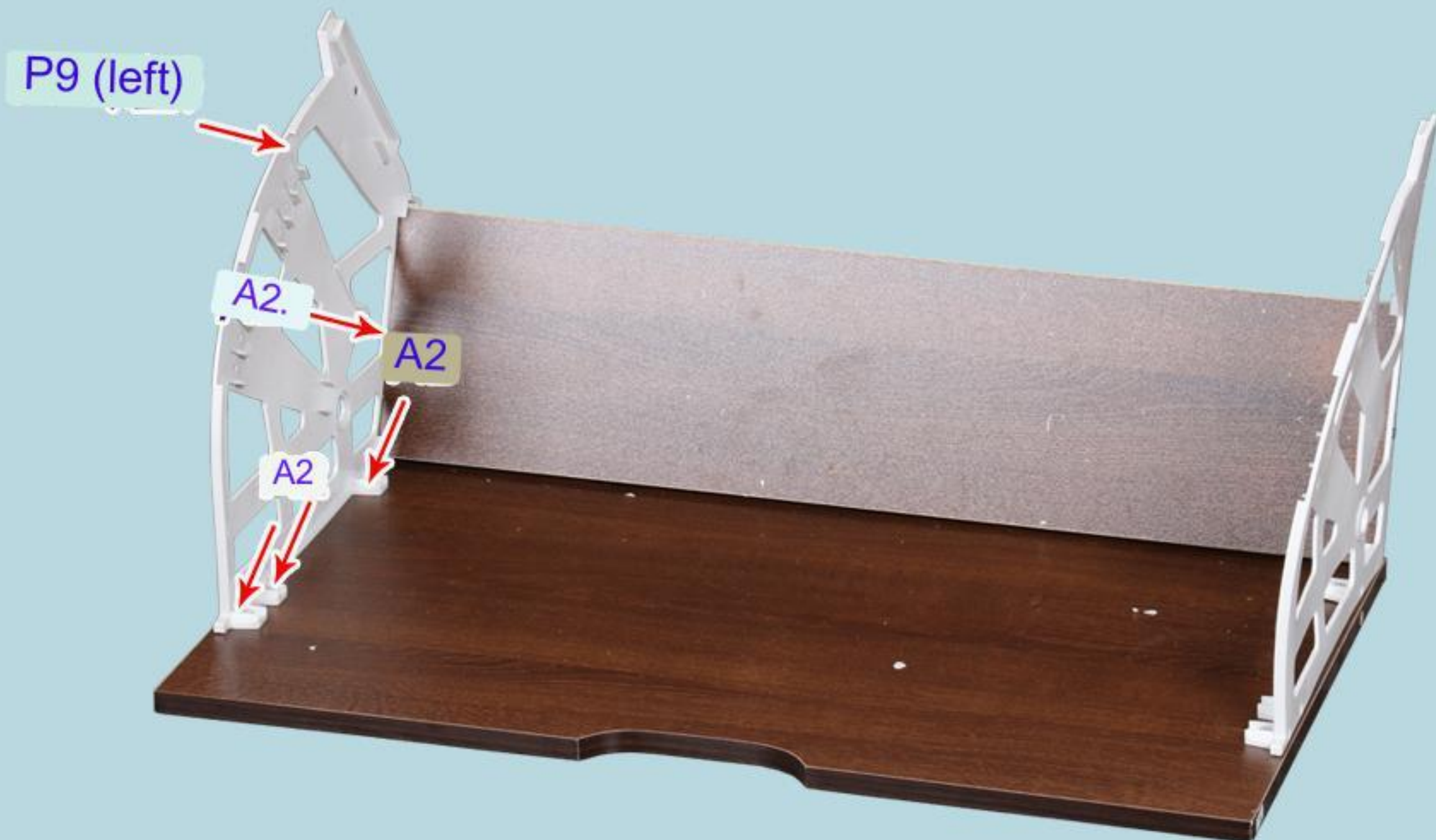

As shown in the picture, the screw that the screwdriver points to is to fix the door panel on the side panel. First loosen the screw clockwise, then adjust the position of the door panel up and down, adjust the door panel to be flush, and then tighten the screw clockwise.

<4>



	
3.5*14 self-tapping screw	Three-layer plastic tipping bucket hinge
A2*4	P9(left)*1

<5>



© Tipping bucket pull plate

3.5*14 self-tapping screw
A2*2

<6>

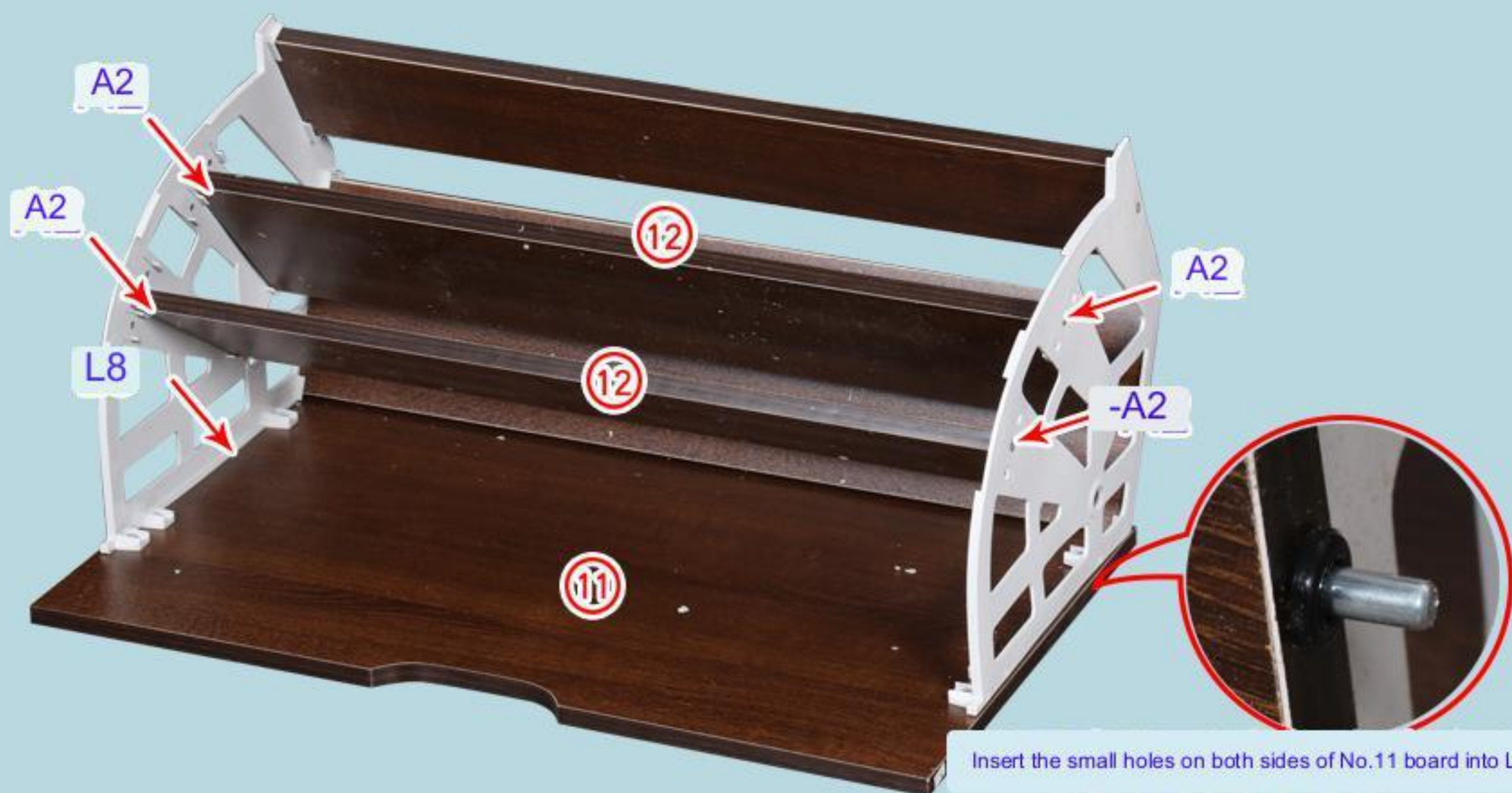

Insert the small holes on both sides of No.11 board into L8



② Tipper deck

The tipping part is installed

	
spring shelf pin	3.5*14 self-tapping screw
L8*2	A2*4

4. Overall part installation

<1>

Circle the large hole on the No. 1.2 plate and plug it into S15



① left side panel





② Middle vertical board

tipping block
S15*2

Fix FO with A1 on No.4 board



	
3.5*12 self-tapping screw	Boxer hinge
A1*4	F0*2

<2>



4*40 self-tapping screws
B4*4

① left side panel

③ Right side panel

④ on the back pull plate

<3>



⑦ Large plywood

4*40 self-tapping screws
B4*4

Board No. 2 circled S15 is up and facing left

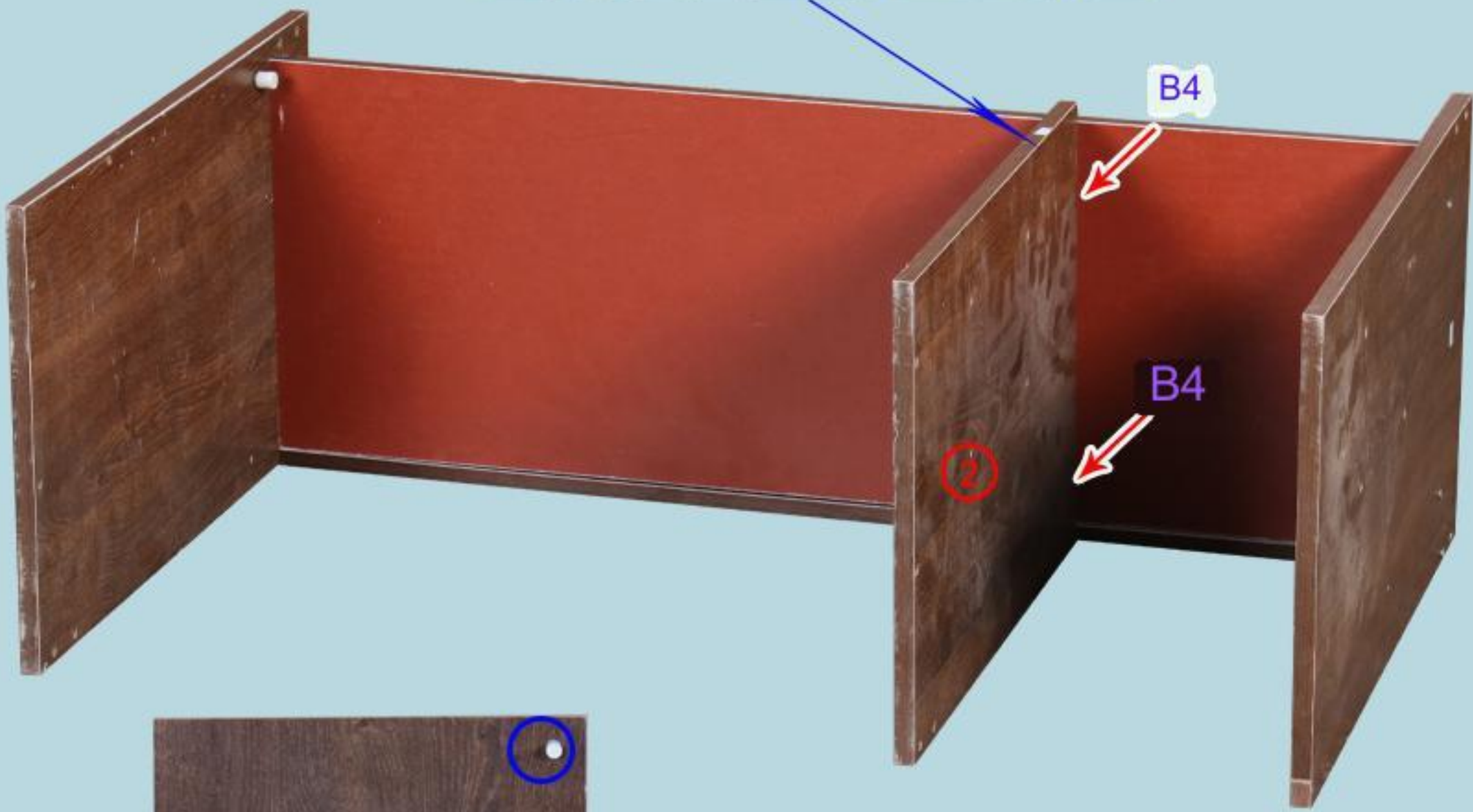

② Riser

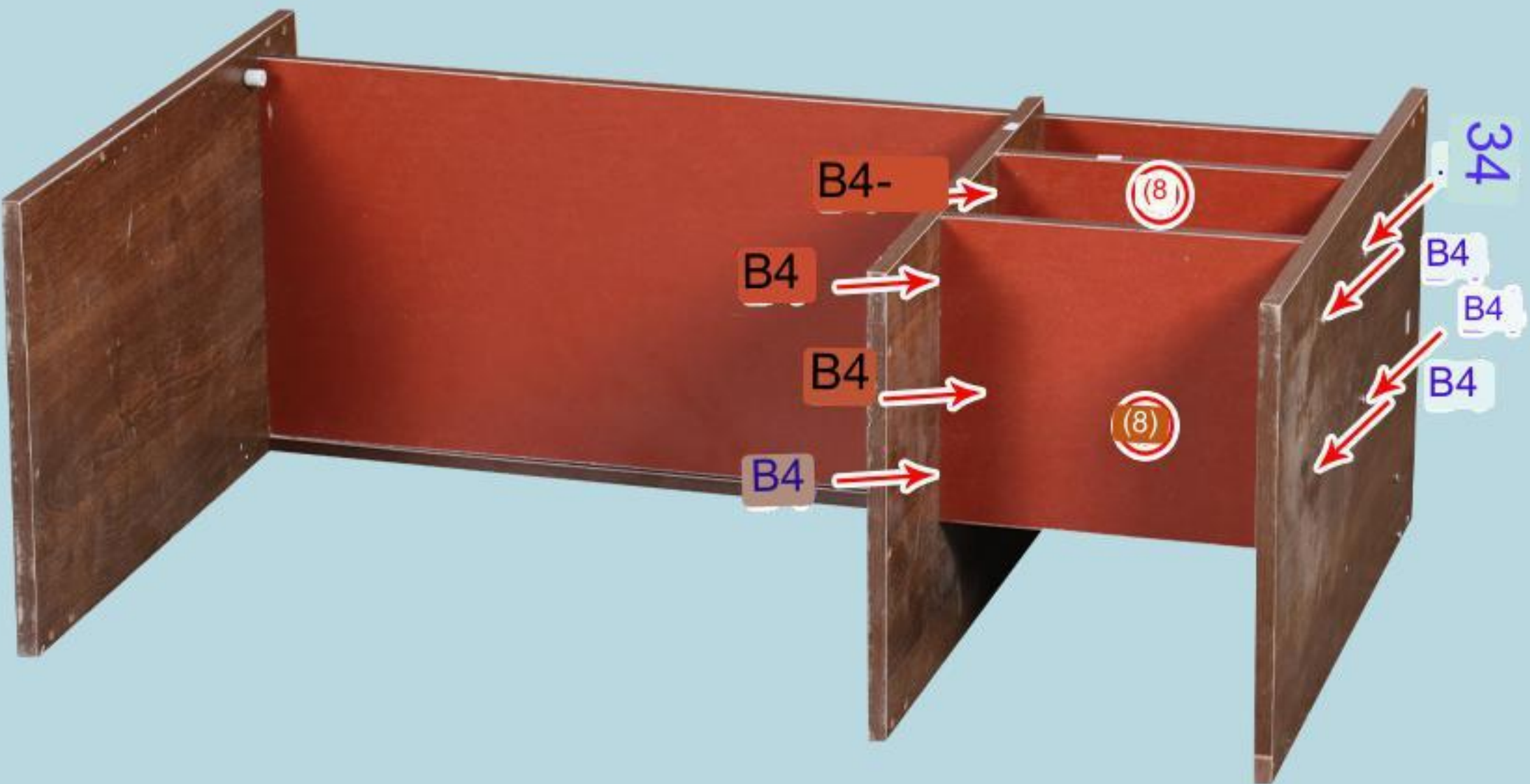

⑧ Small plywood

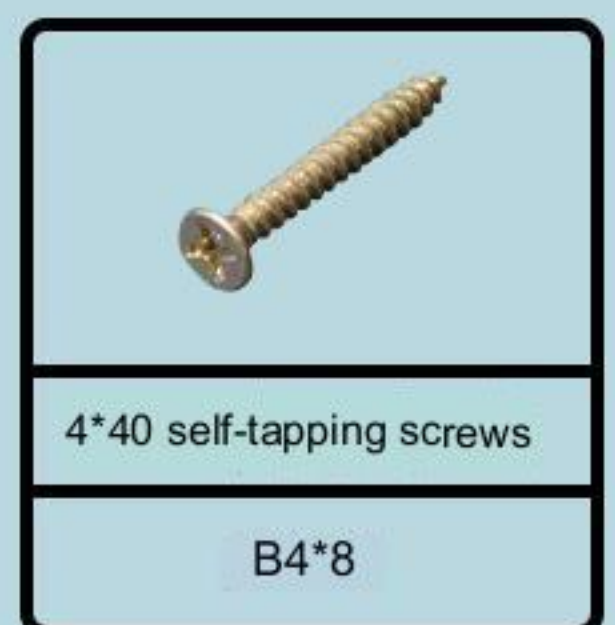

<6>

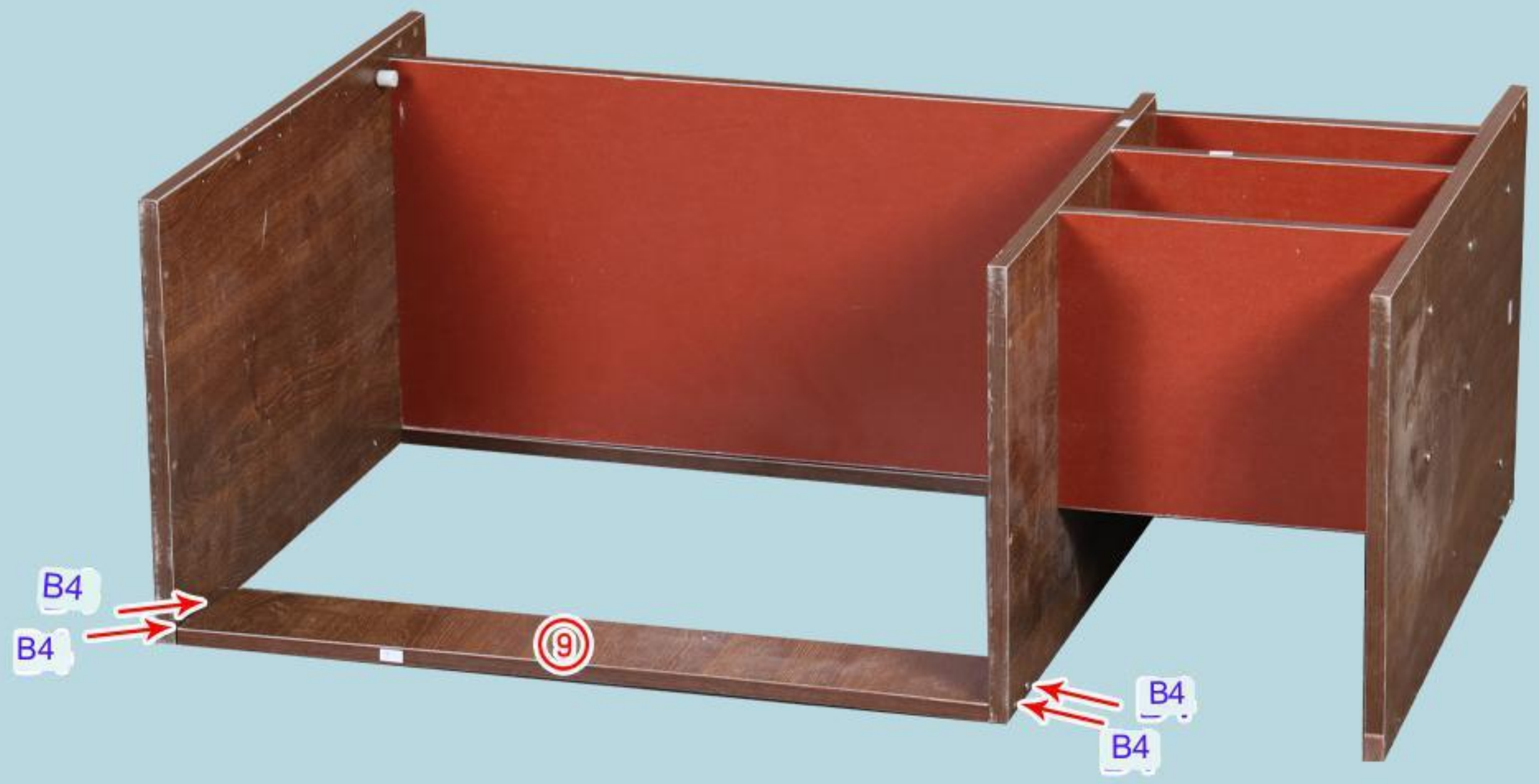

9 drop plate

4*40 self-tapping screws
B4*4

<7>

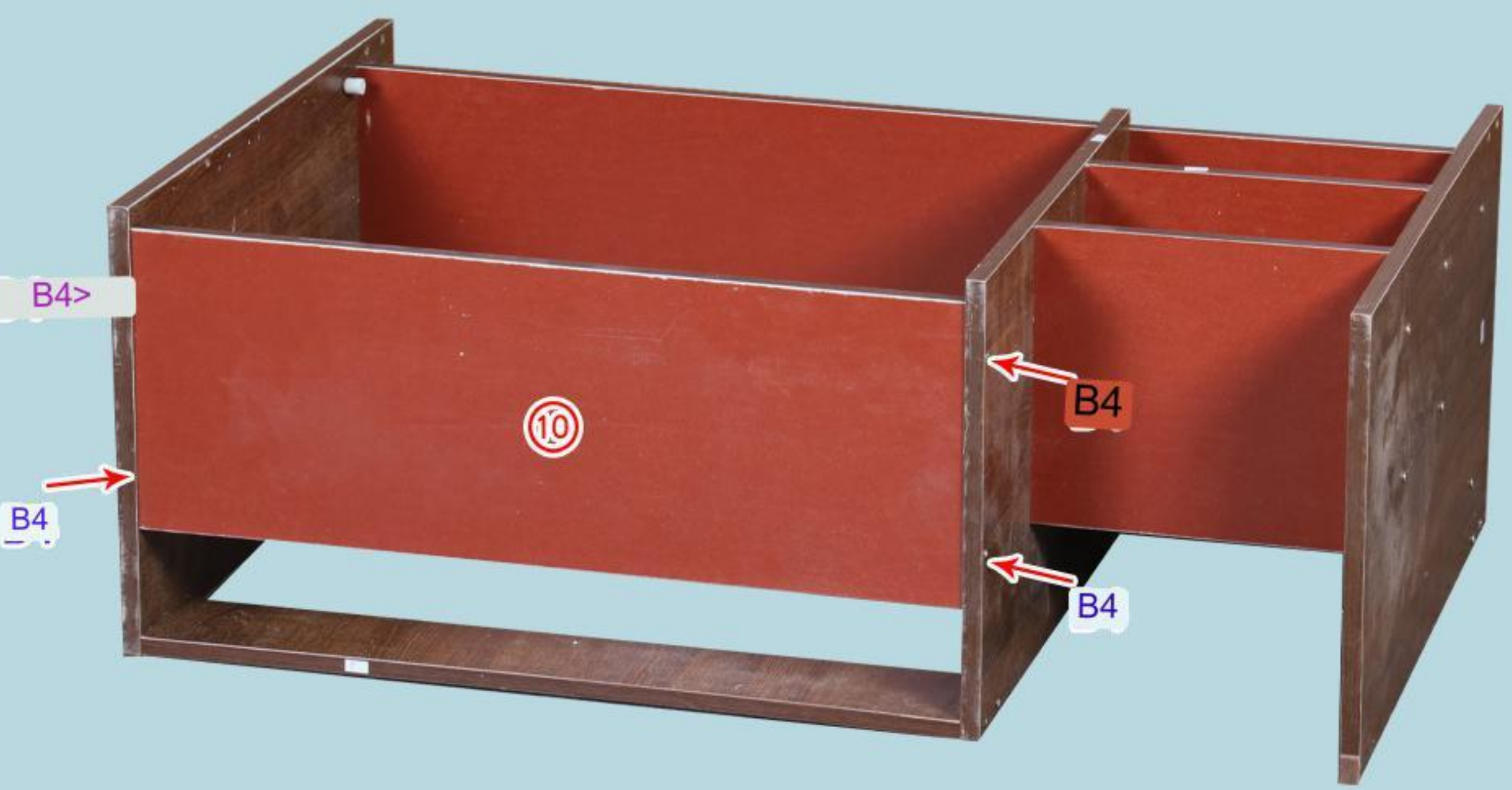

10 Bottom plate

4*40 self-tapping screws
B4*4

<8>

straighten the whole



(5) Partition

4*40 self-tapping screws
B4*2

<9>

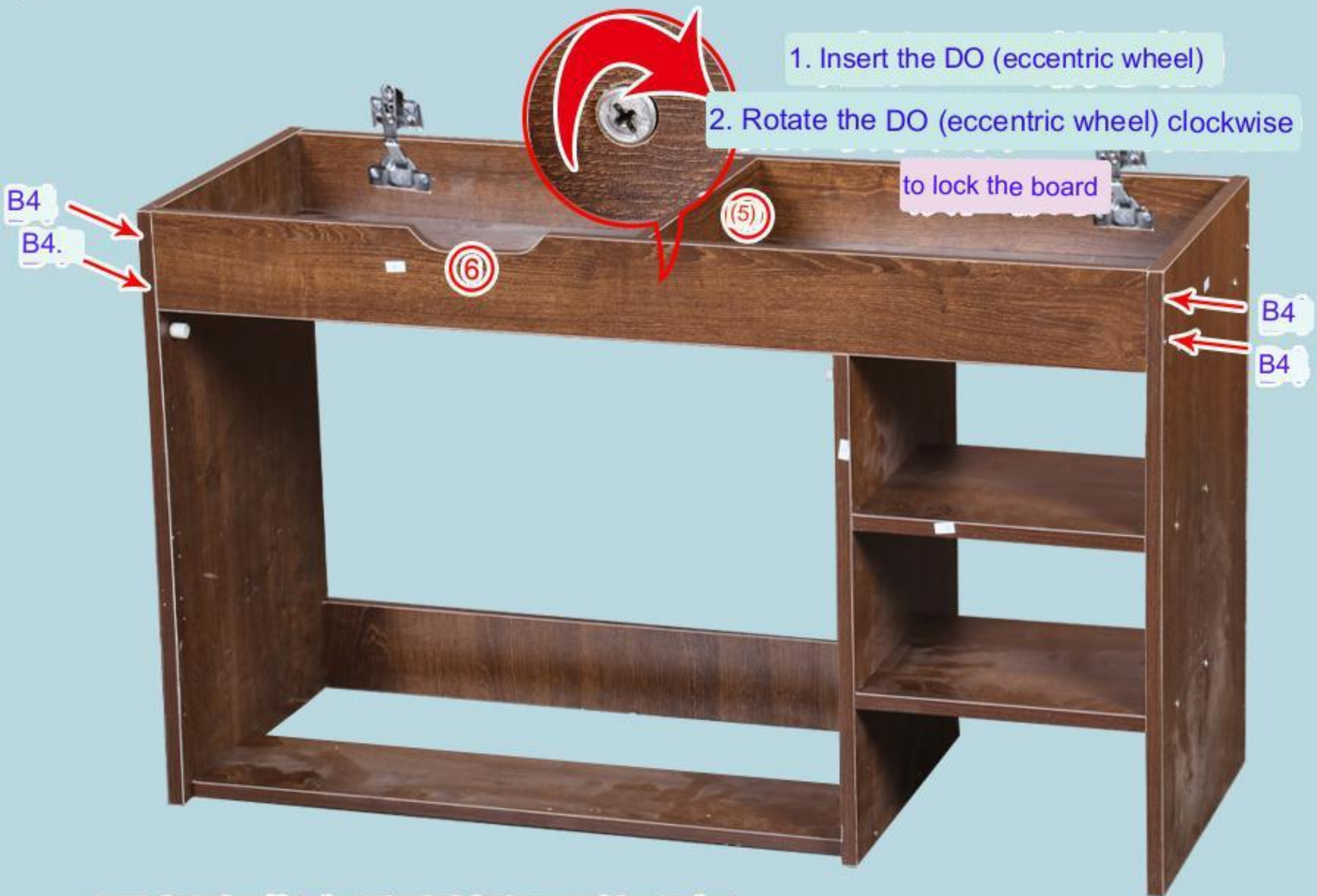

The non-penetrating hole on No. 6 plate is screwed into the DO eccentric rod

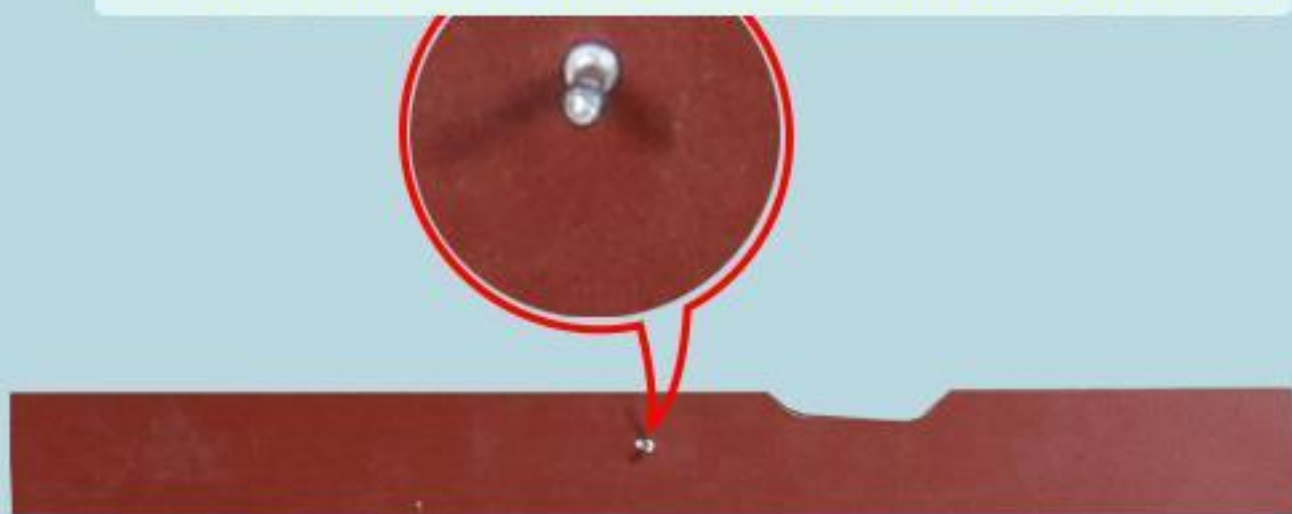

(6) Upper front baffle

	
Eccentric rod + eccentric	4*40 self-tapping screws
wheel D0*1	B4*4

Press and hold L8 on both sides of the dump bucket

Push the meat into the small hole of No. 1 and No. 2 plates



Tipping part

Fixed FO on board No. 4



complete drawing

