

# SOCE026 Installation Instruction

Please be sure to use a manual screwdriver and refrain from using an electric drill.

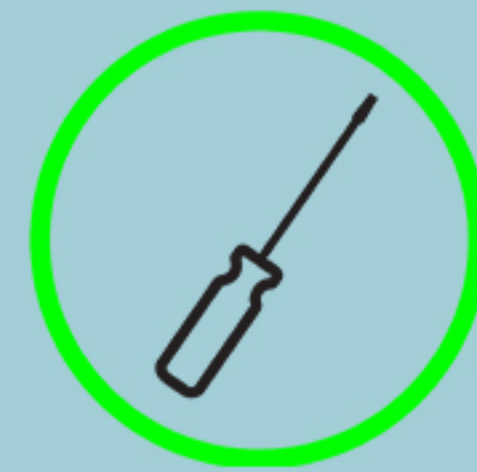

A*12	B*12	C*20	D*36	E*60	F*6	G*6	H*6	I*6	J*6

Principle of installation of eccentric parts: Warm reminder: Tighten the screws 70% when installing, and then tighten again after everything is completed!

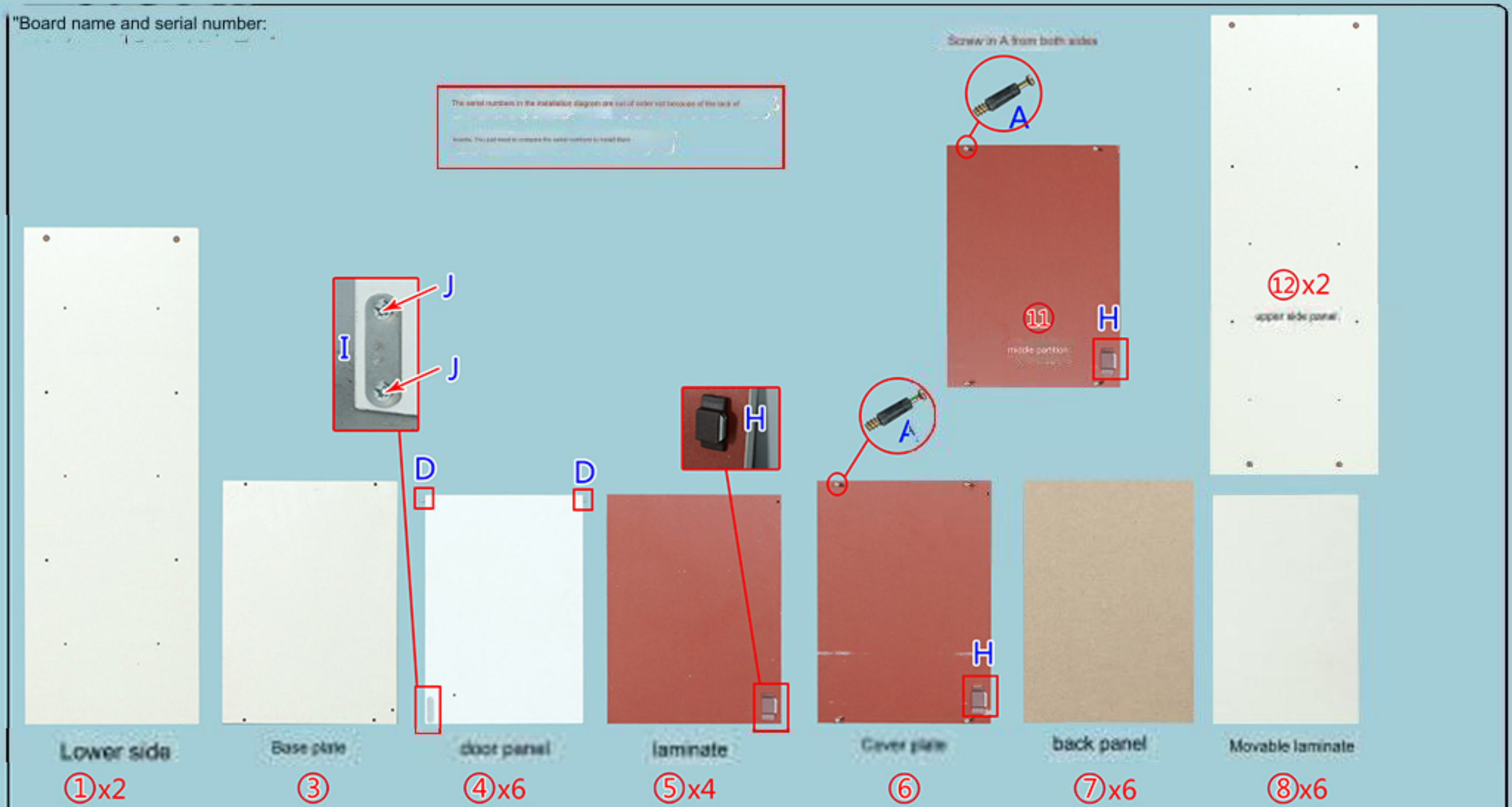



# Step 1: Whole part installation

<1>

The small hole and door stopper hole forward and downward.

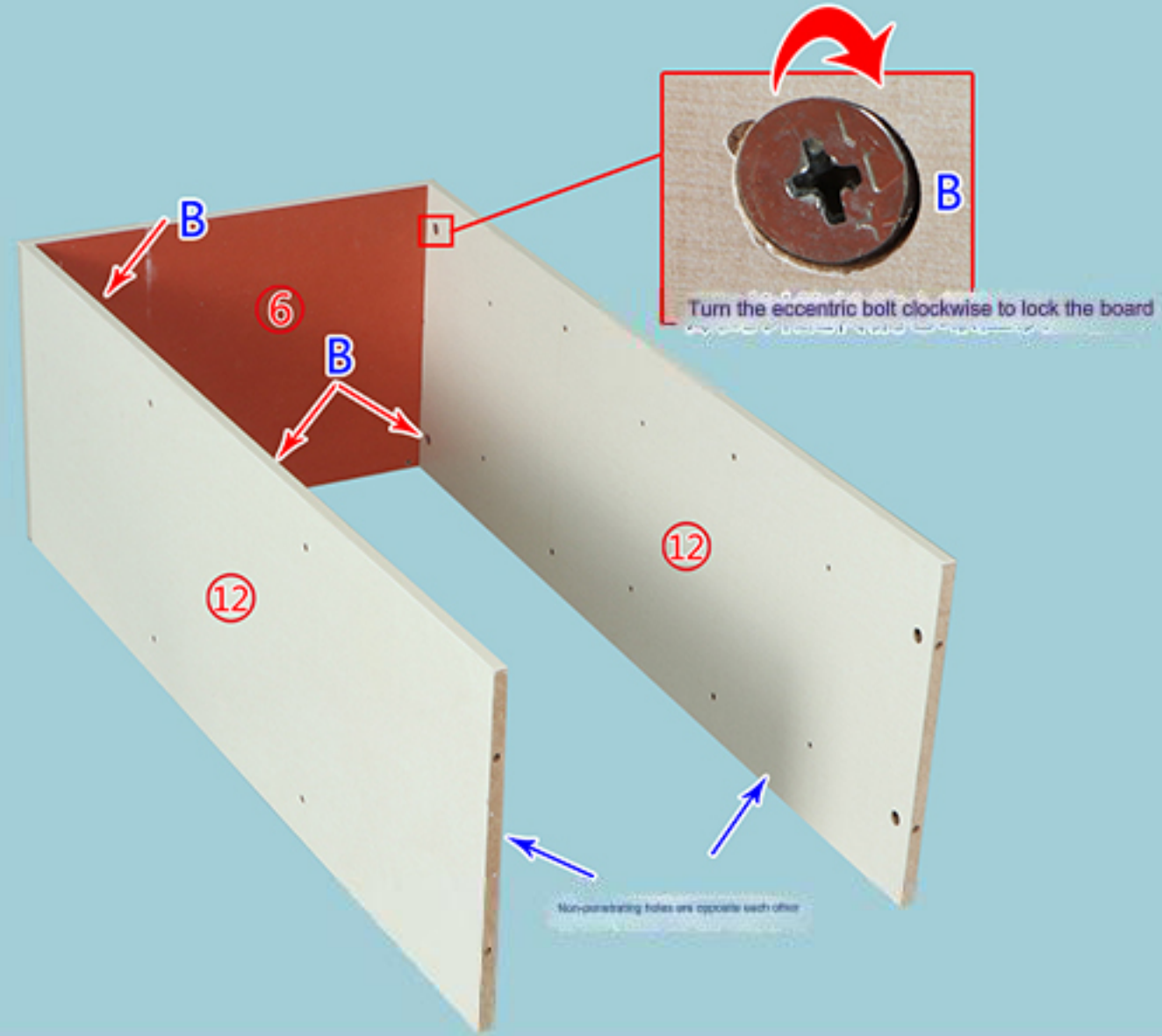

<2>

Insert the metal pin on the door panel into the small hole on the cover plate, and align the door two plates with the bottom of the door assembly.

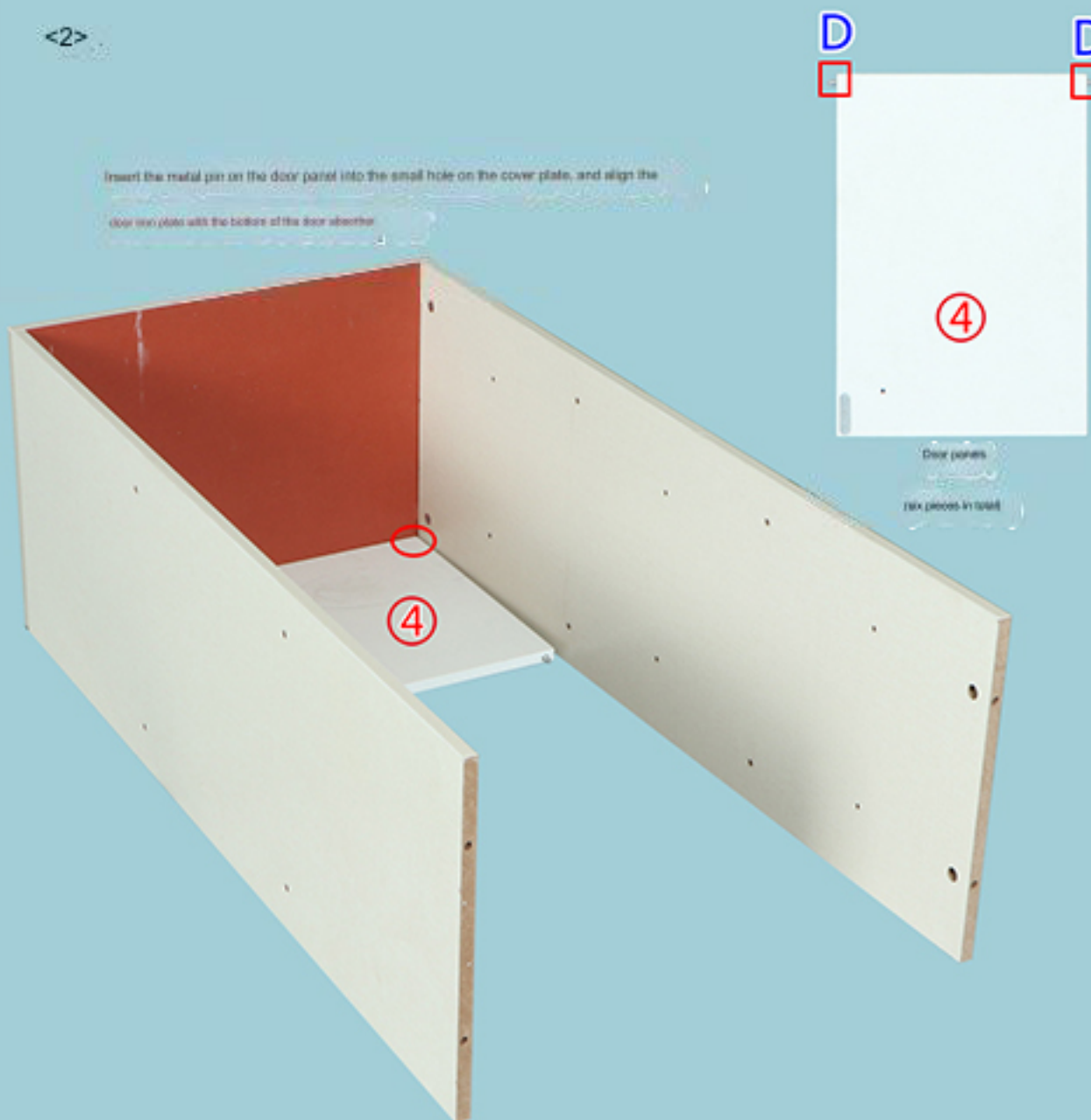

<3>

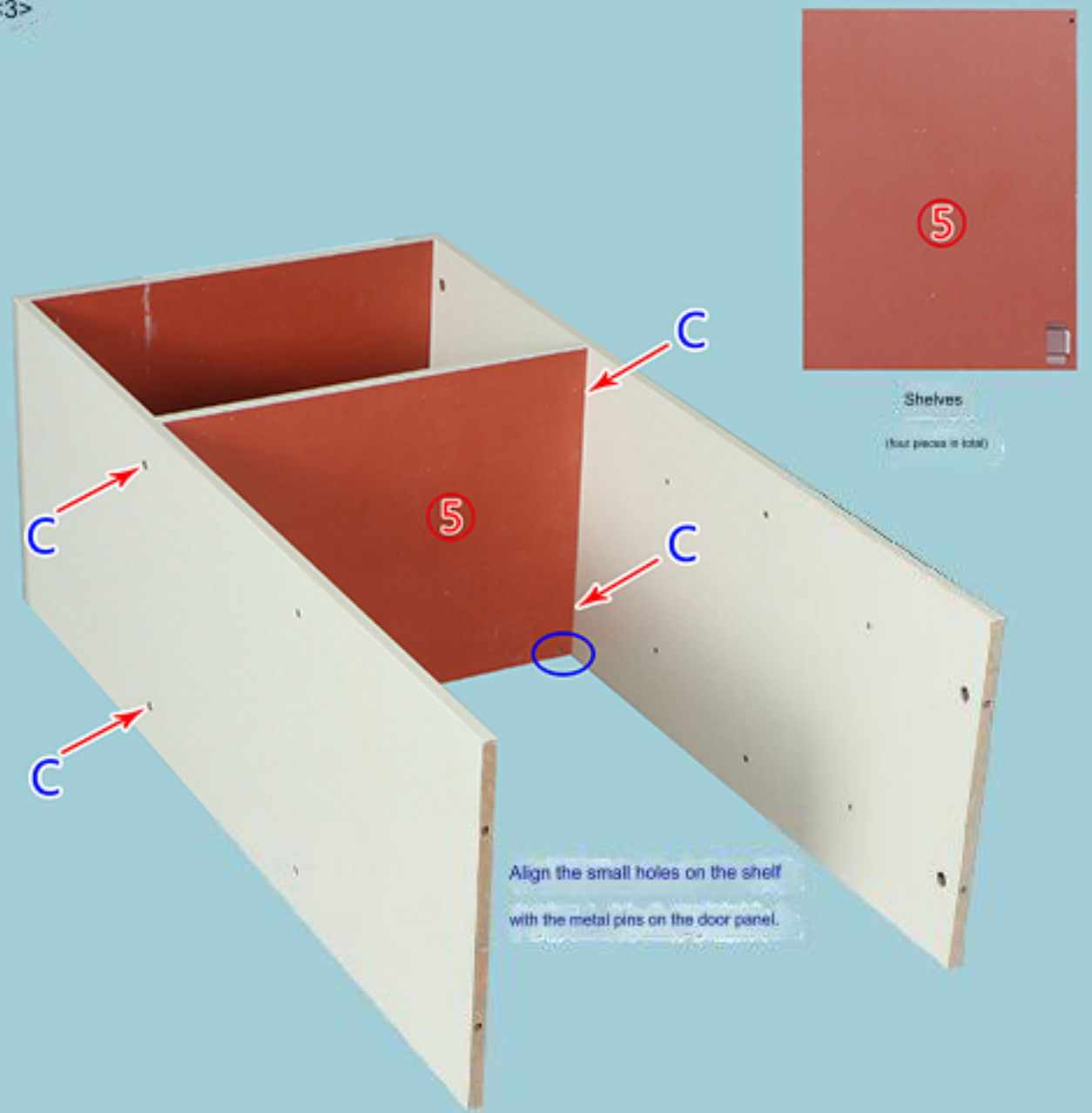

<4>

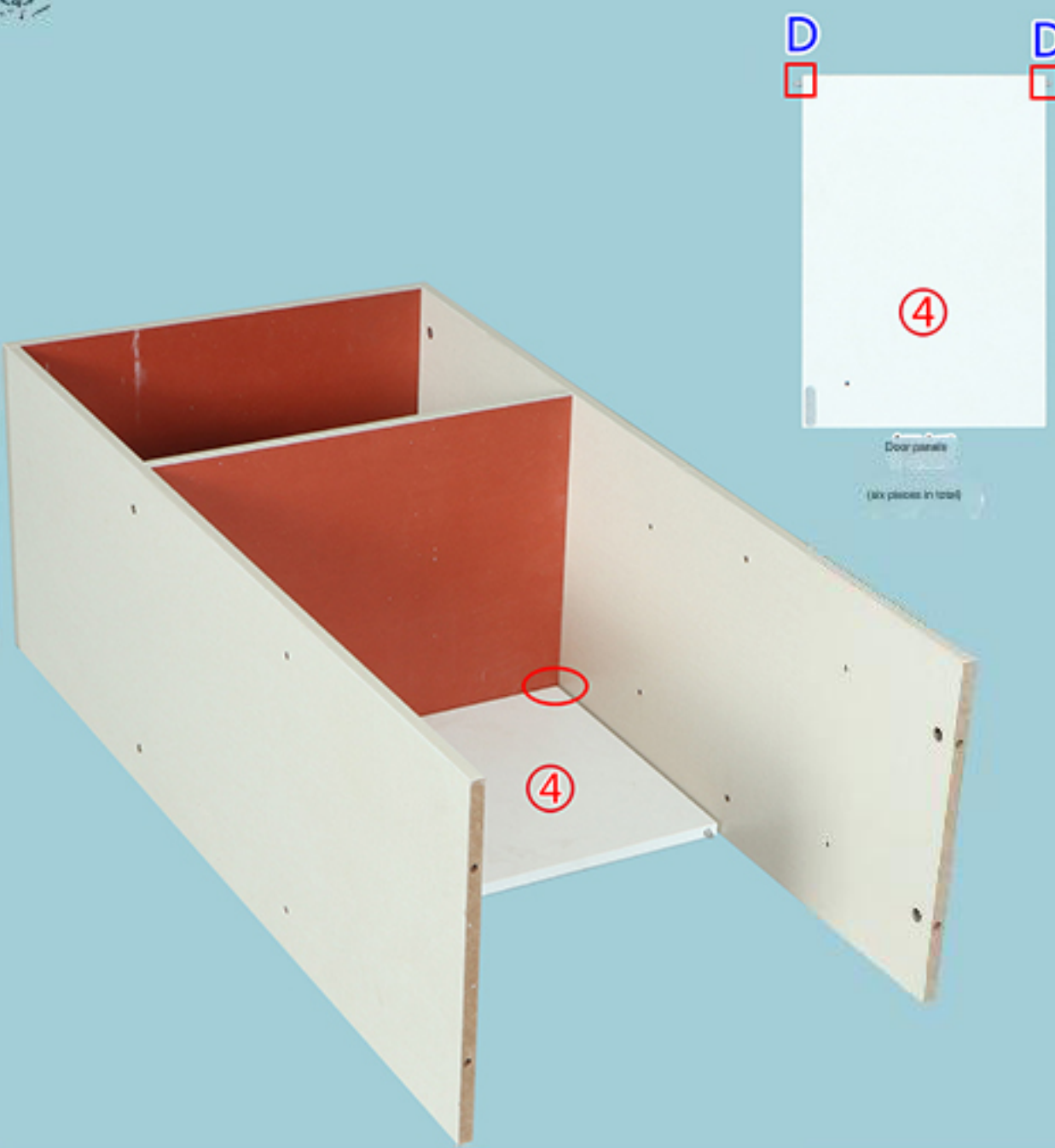

<5>

