

# SOCE016 Installation Instructions

					
A*13	B*36	C*6	D*6	E*30	F*18
3.5CM self-tapping screw/minimum self-tapping screw		shaft	Card column	small nail	small nail

Kind tips:

Tighten it when you're all done!

installation steps:

Board name and serial number:

The serial number in the instruction manual is not a lack of boards, just check the serial number to install



The parts list includes: Left sector piece (1x3), Right sector slice (20x3), Tipper floor (3x3), Door panels (4x3), Bucket shelf (5x3), left side panel (6), right side panel (7), cabinet cover (8), pull-up plate (15), and Pull down (plate 16). A note indicates that the circled position on the cabinet cover has a small hole on the side.

Step 1: Tipper part installation

<1>

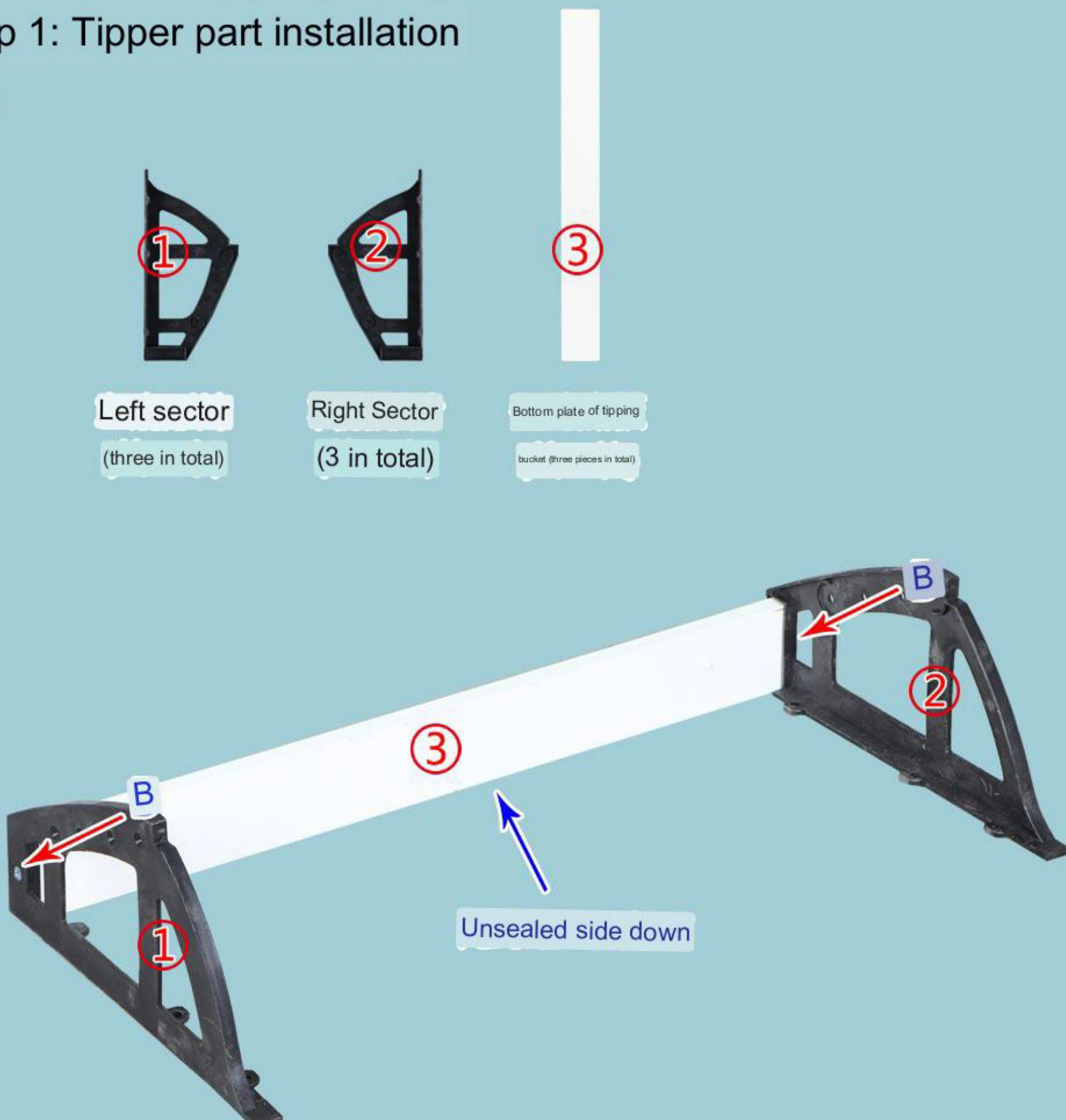

This diagram shows the assembly of the tipper mechanism. It includes three left sectors (1), three right sectors (2), and three bottom plates of tipping (3). The assembly is shown being attached to a white base. Red arrows labeled 'B' indicate the direction of force applied to the sectors. A blue arrow labeled 'Unsealed side down' points to the bottom of the assembly.

<2>

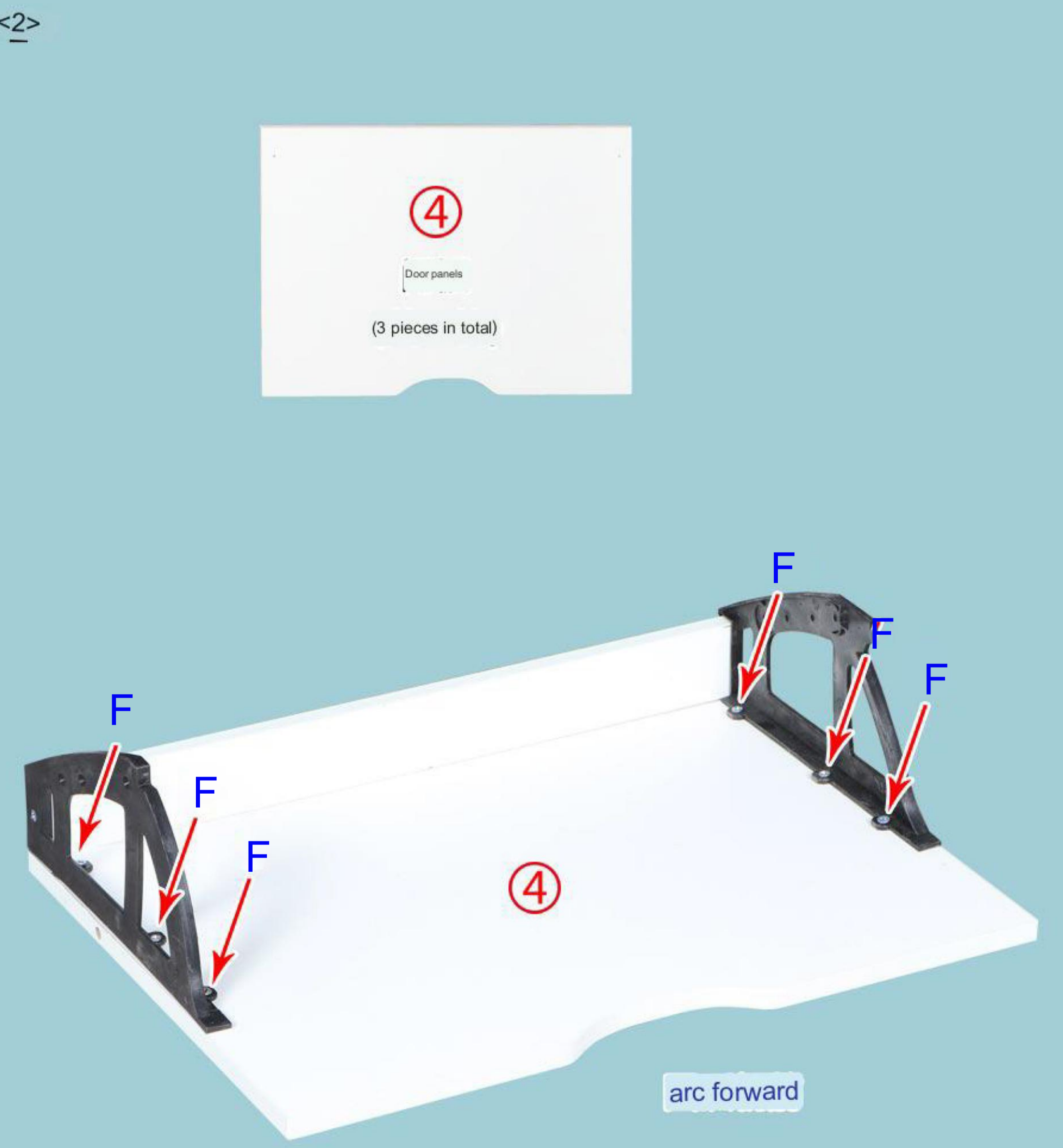

This diagram shows the installation of the door panels (4). Three door panels are shown being attached to the tipper mechanism. Red arrows labeled 'F' indicate the force applied to the panels. A blue arrow labeled 'arc forward' indicates the direction of movement for the panels.

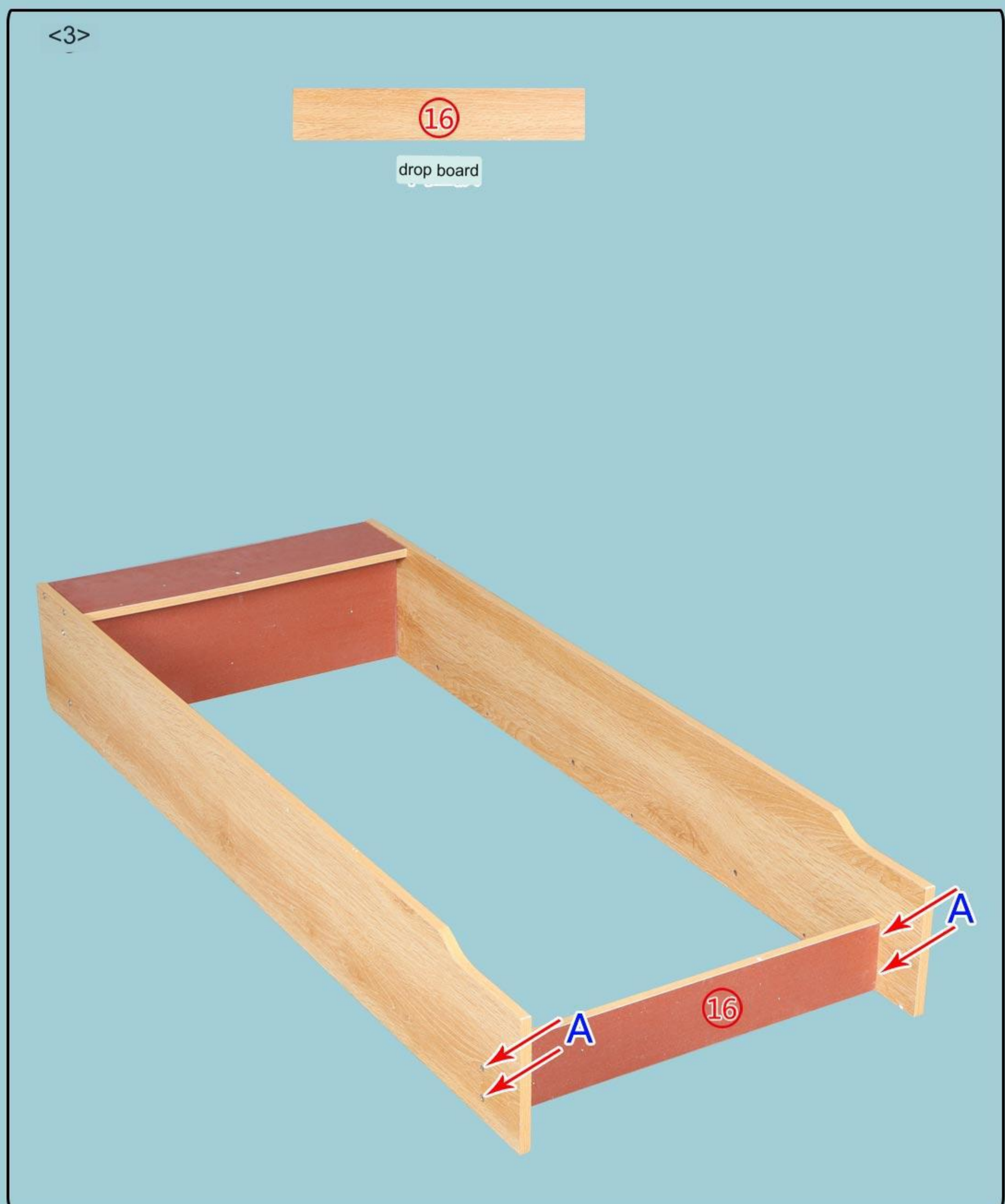
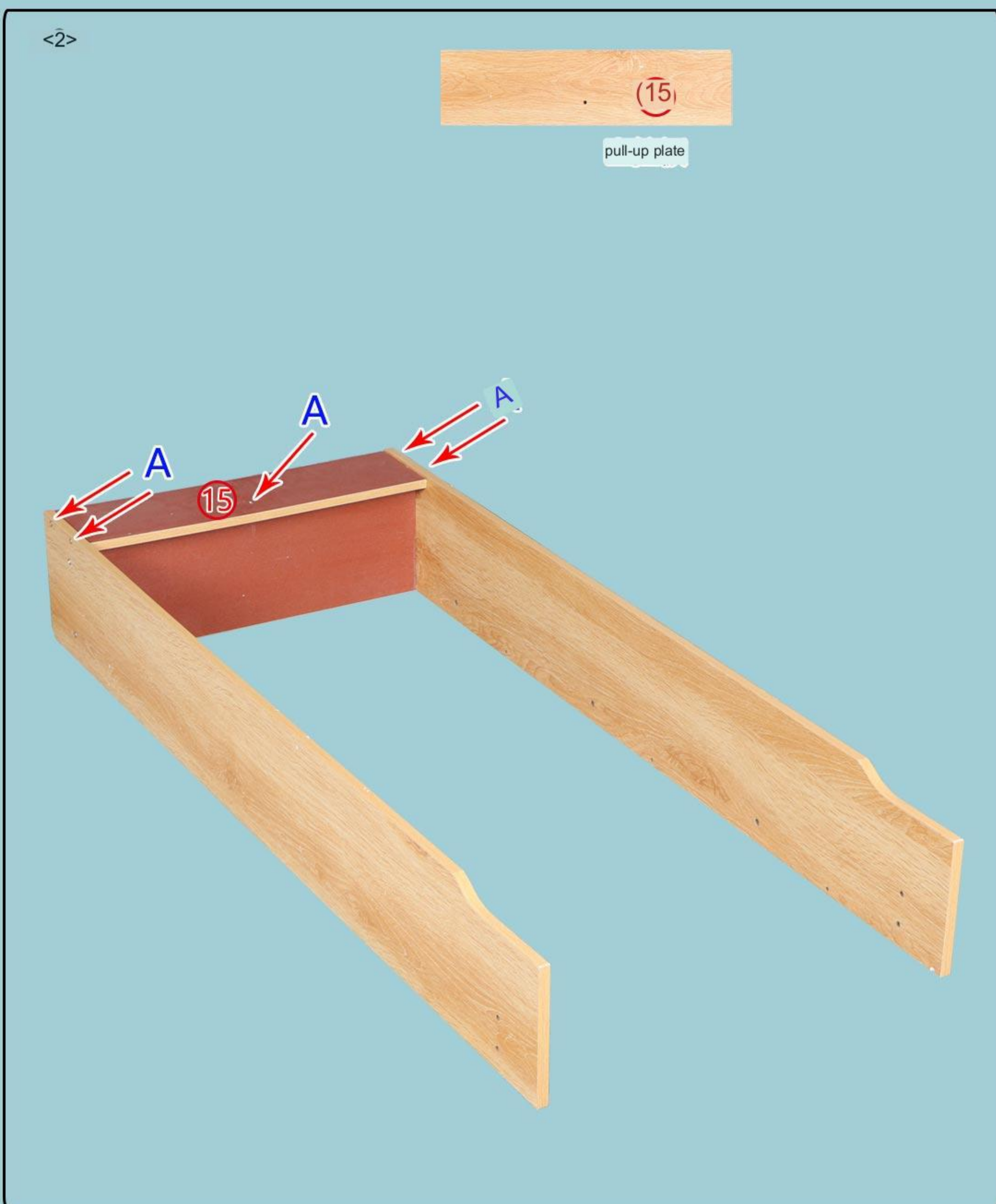
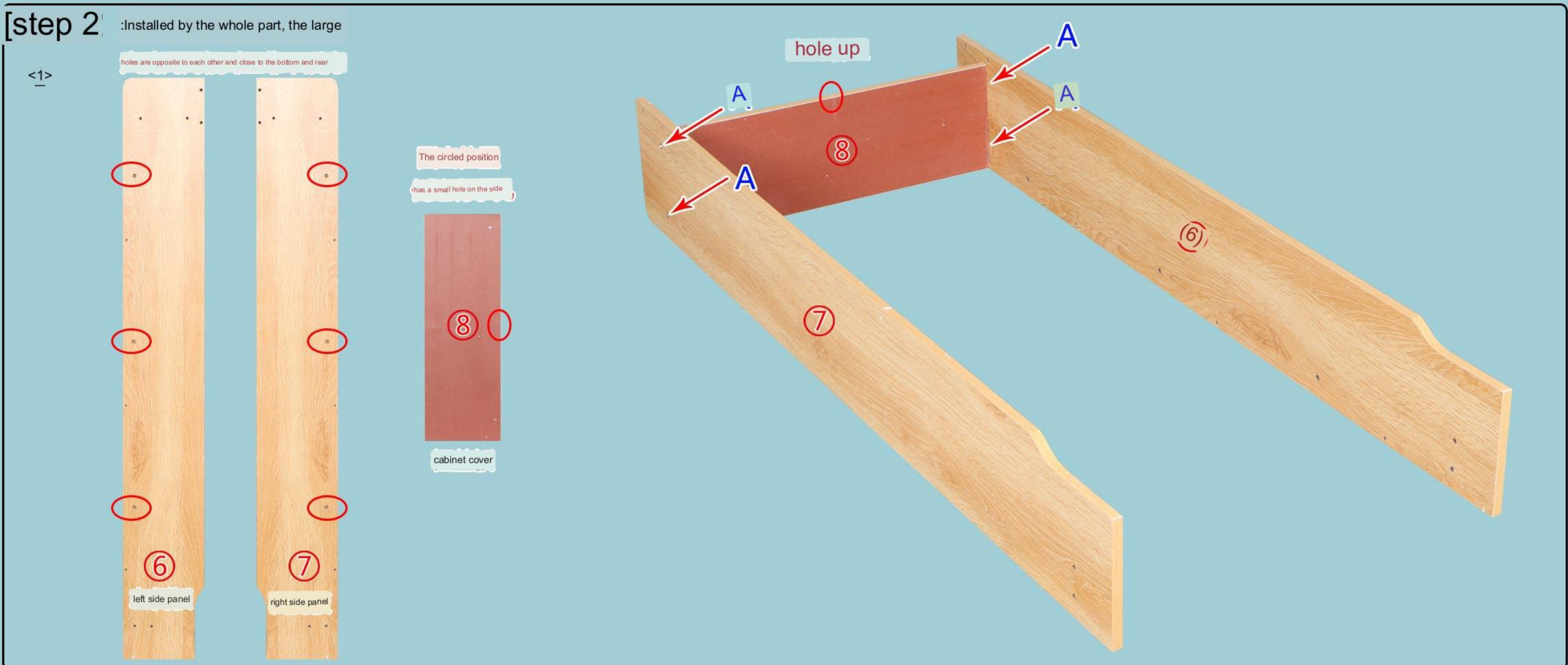

<4>

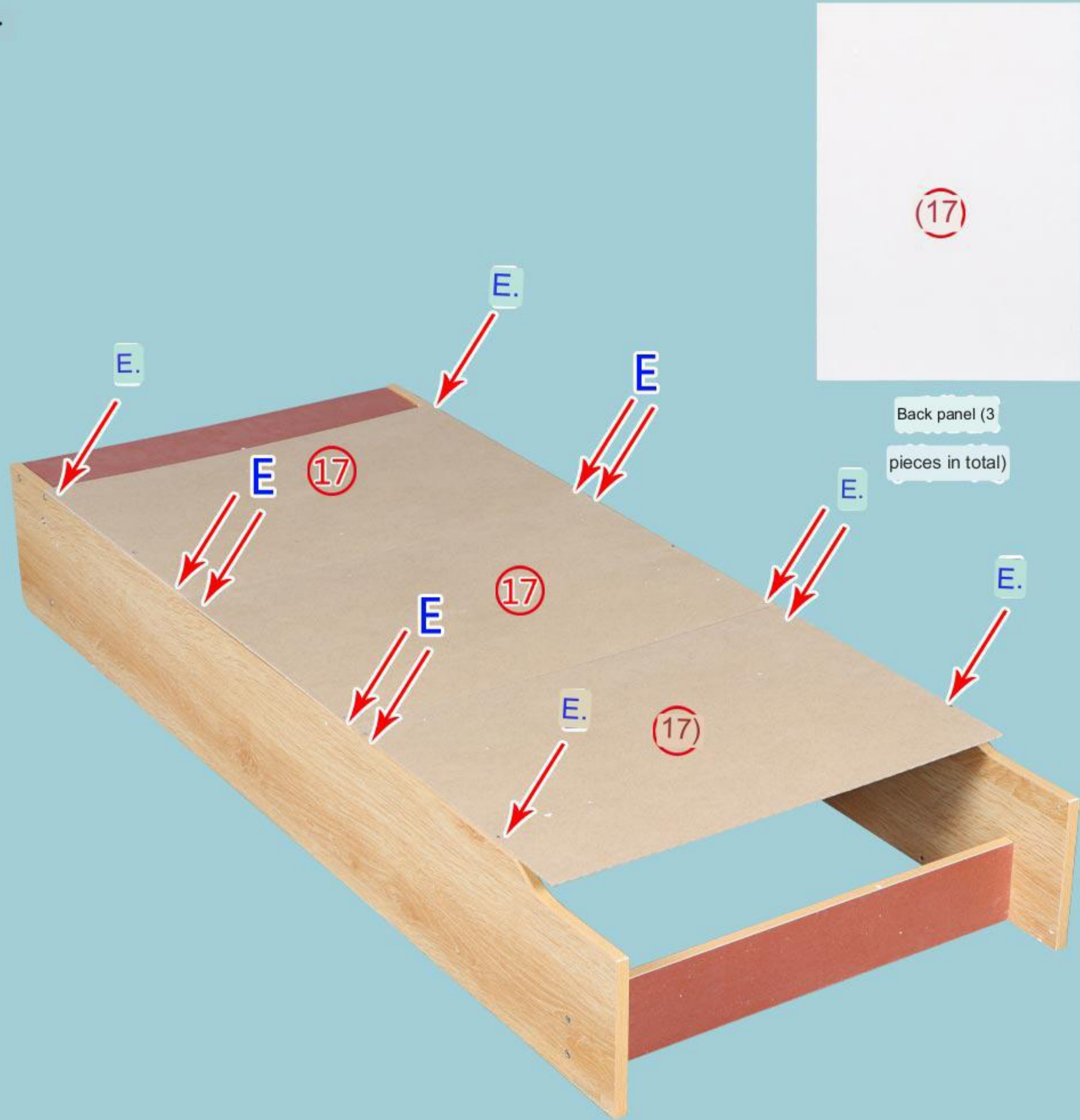

<5> overall alignment

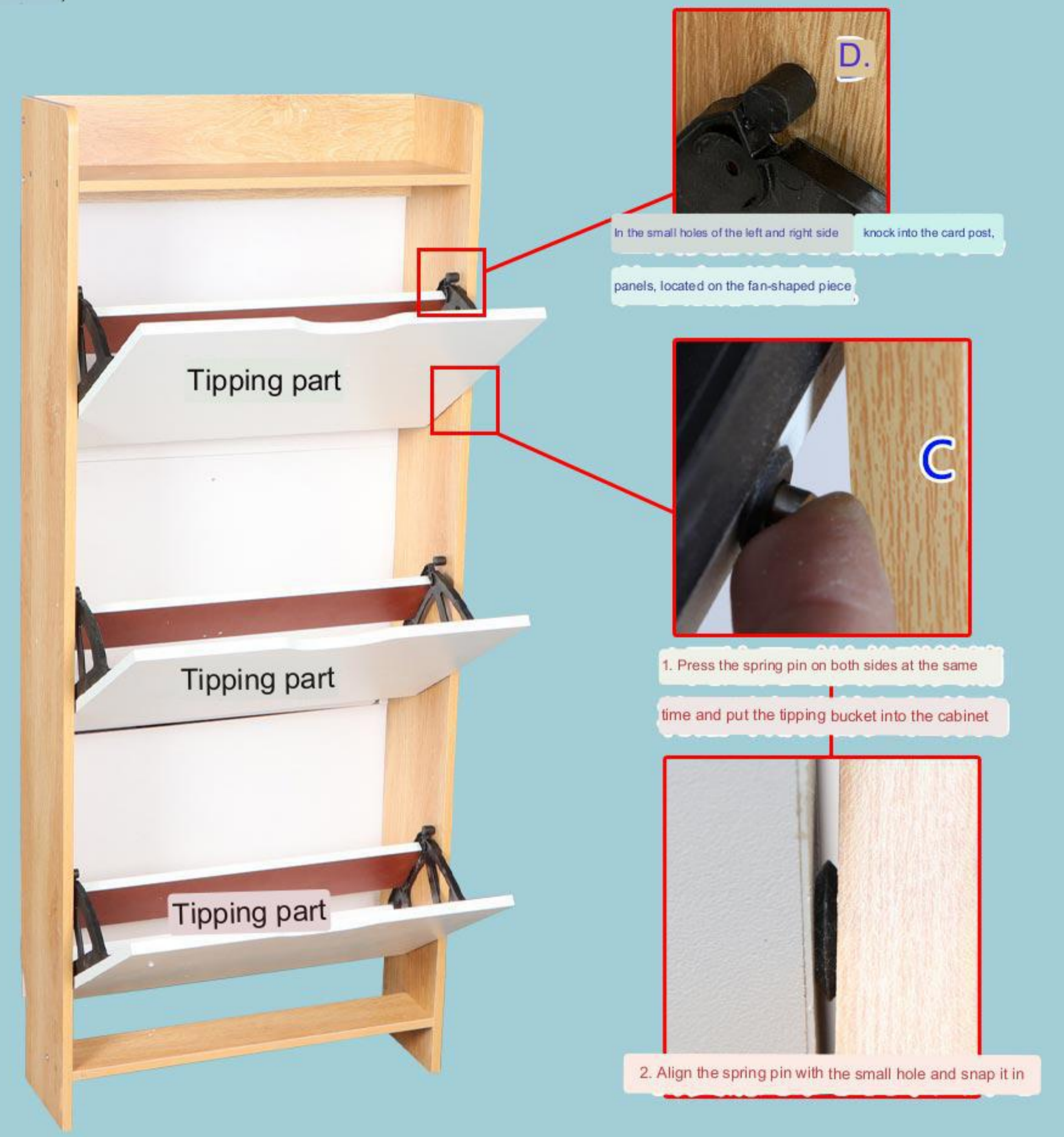

<6> Installation complete



Complete drawing!