

CC025 Installation Instruction

Please be sure to use a manual screwdriver and refrain from using an electric drill.



The installation is complete



cabinet door hinges



handle



self tapping



nail



black screw



Hardware Accessories



Hand screw



Clothes pole holder



Clothes rail



screwdriver



Lock



Bai Zi







Install black screws on the white plate



Install black screws on the white plate

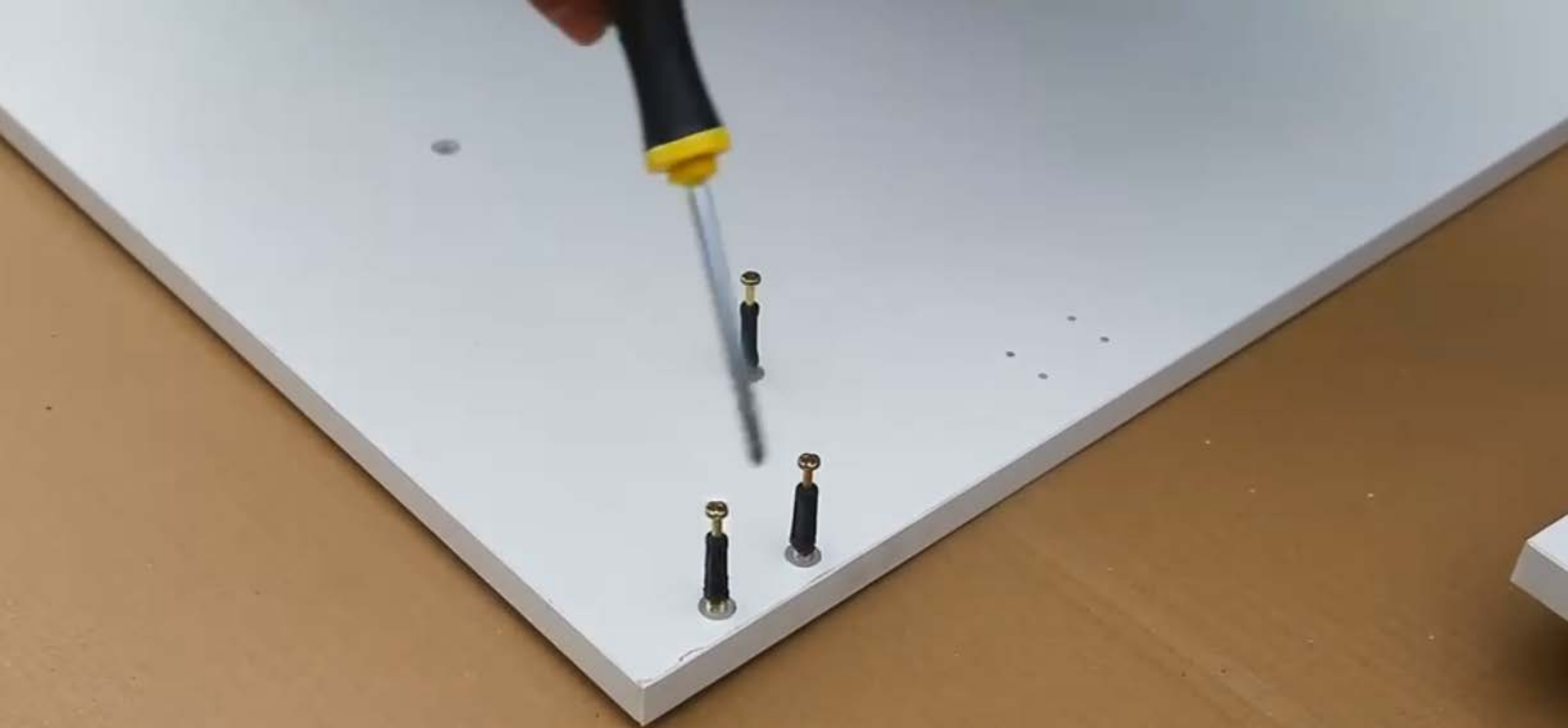

Install black screws on the white plate



Black screws need to be installed on the front and back sides of the base plate, large shelves, and middle partitions.



Black screws need to be installed on the front and back sides of the base plate, large shelves, and middle partitions.



Black screws need to be installed on the front and back sides of the base plate, large shelves, and middle partitions.



Black screws need to be installed on the front and back sides of the base plate, large shelves, and middle partitions.

Seek



Black screws need to be installed on the front and back sides of the base plate, large shelves, and middle partitions.



Seek



Install the connection between large shelves and back slats



Install the connection between large shelves and back slats



Install the connection between large shelves and back slats



Install vertical partitions



Install the connection between large shelves and back slats



Install vertical partitions



Install vertical partitions



Install large shelves



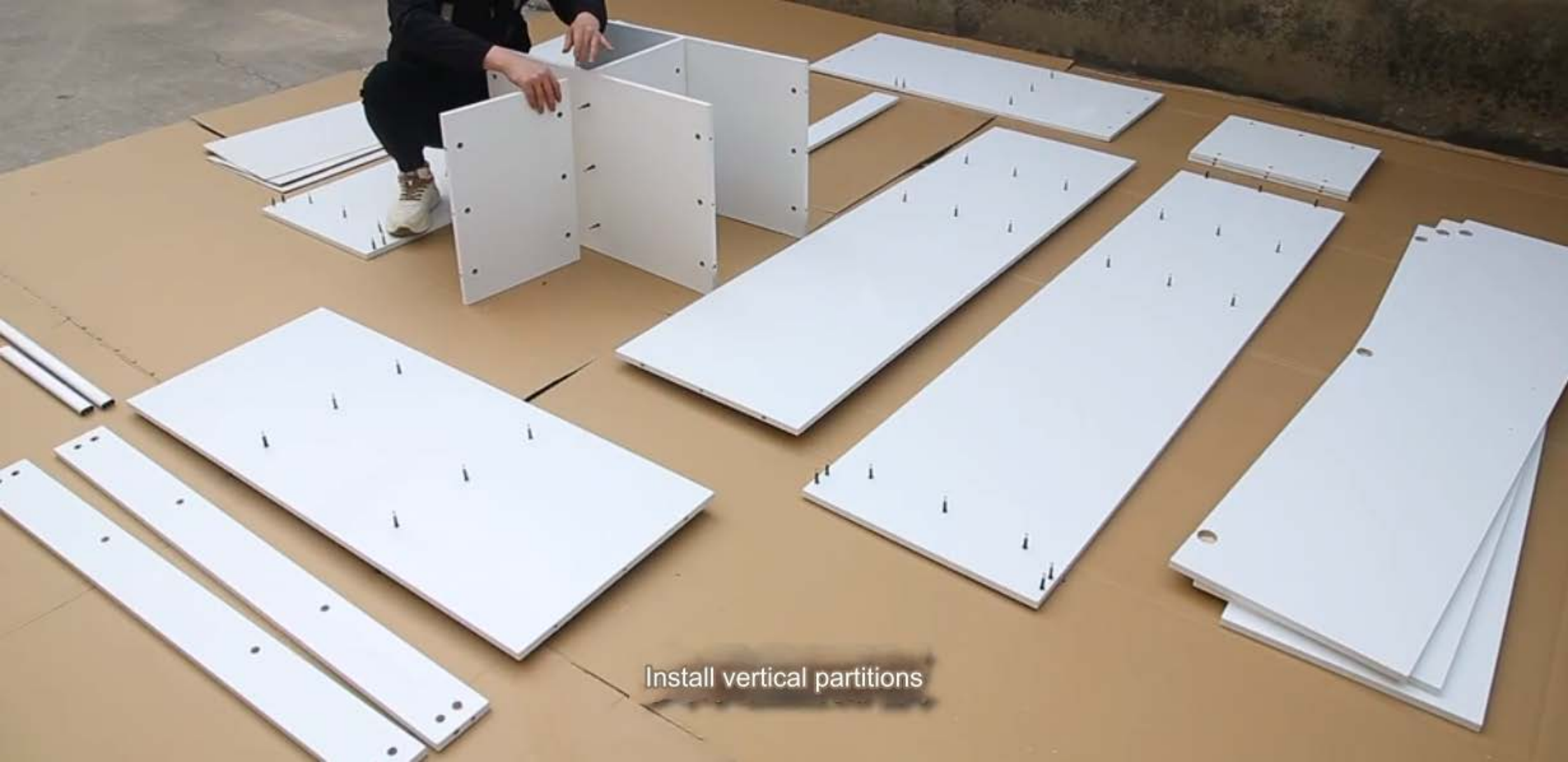

Install vertical partitions



Install the middle partition



Install the middle partition



Install the middle partition





Install base plate



Install base plate





Install two baseboards



Install two baseboards



Install two baseboards



Install two baseboards







Install two small shelves



Install two small shelves



Install two small shelves



Install top plate



Install left side panel



Install left side panel



Install the right side panel





Tighten all locks to secure the cabinet



Tighten all locks to secure the cabinet



Tighten all locks to secure the cabinet



Tighten all locks to secure the cabinet



Tighten all locks to secure



Turn the cabinet over, with the back facing upward, and install the back slat locks

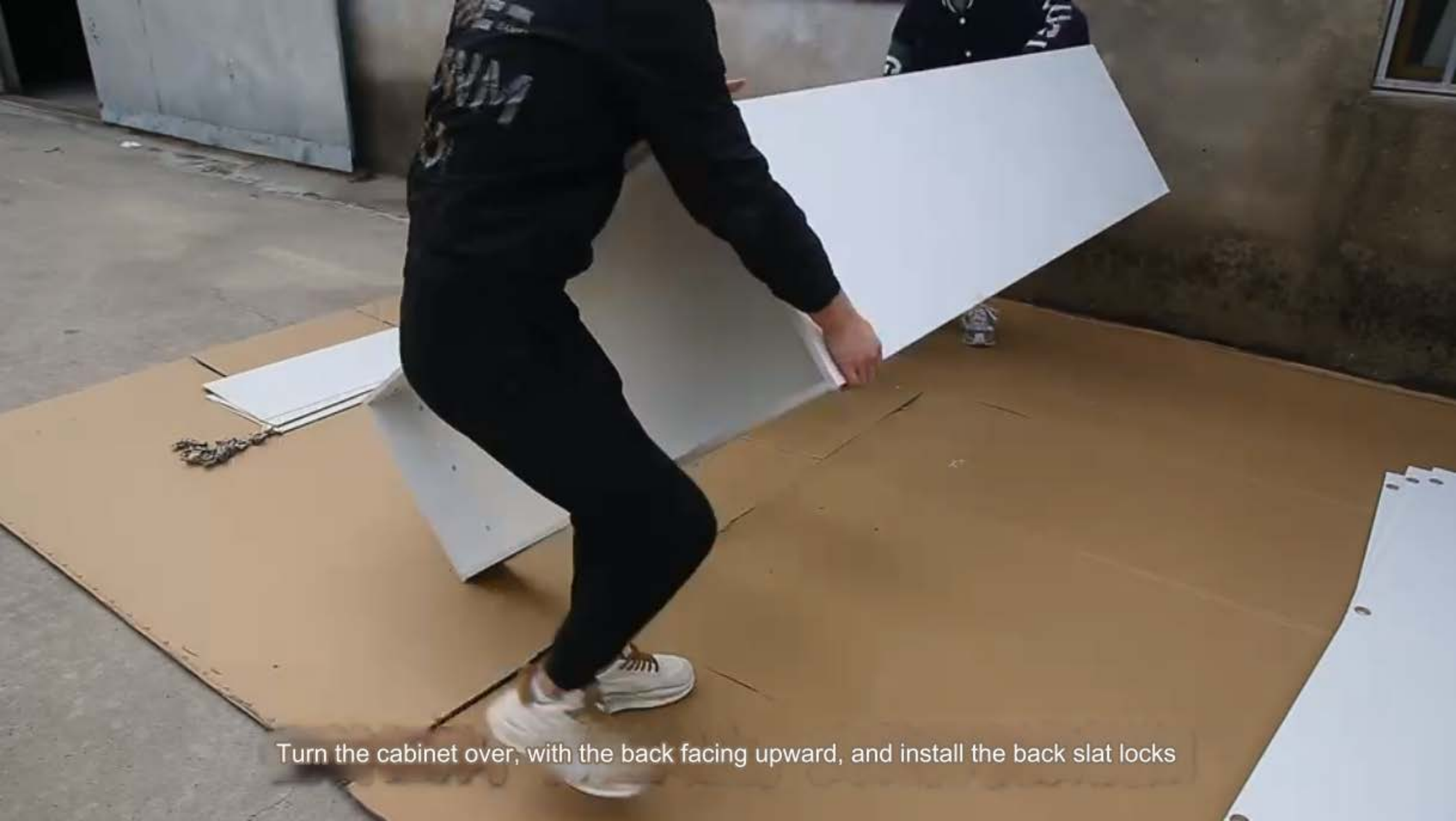

Turn the cabinet over, with the back facing upward, and install the back slat locks



Turn the cabinet over, with the back facing upward, and install the back slat locks



Place the back plate and align the back plate with the top plate



Place the back plate and align the back plate with the top plate



Drill nails to secure the back panel



Drill nails to secure the back panel



Drill nails to secure the back panel



Turn the cabinet over, right side up



Install cabinet door hinges and use self-tapping screws to fix them



Install cabinet door hinges and use self-tapping screws to fix them



Install cabinet door hinges and use self-tapping screws to fix them



Install cabinet door hinges and use self-tapping screws to fix them



Install cabinet door hinges and use self-tapping screws to fix them



Install cabinet door hinges and use self-tapping screws to fix them



Install the cabinet door on the left and right side panels and the middle partition, and use self-tapping threads to fix the cabinet door hinges



Install the cabinet door on the left and right side panels and the middle partition, and use self-tapping threads to fix the cabinet door hinges



Install the cabinet door on the left and right side panels and the middle partition, and use self-tapping threads to fix the cabinet door hinges



Install the cabinet door on the left and right side panels and the middle partition, and use self-tapping threads to fix the cabinet door hinges



Install the cabinet door on the left and right side panels and the middle partition, and use self-tapping threads to fix the cabinet door hinges



Install the cabinet door handle and fix it with handle screws



Install the cabinet door handle and fix it with handle screws



Install the cabinet door handle and fix it with handle screws

A white cabinet is shown with its two doors open, revealing internal shelves and drawers. The cabinet is placed on a large piece of brown cardboard on a concrete floor. A person in a black shirt is partially visible in the background, holding a cigarette. The cabinet has black handles on the doors and hinges on the inside of the doors. The text at the bottom of the image reads: "Install the cabinet door handle and fix it with handle screws".

Install the cabinet door handle and fix it with handle screws



When the cabinet doors are uneven, please adjust the two screws on the hinges.



When the cabinet doors are uneven, please adjust the two screws on the hinges.



When the cabinet doors are uneven, please adjust the two screws on the hinges.



When the cabinet doors are uneven, please adjust the two screws on the hinges.



Install top plate



Install the clothes rail support in the middle position, about 8 cm from the top, and use self-tapping screws to fix it



Install the clothes rail support in the middle position, about 8 cm from the top, and use self-tapping screws to fix it

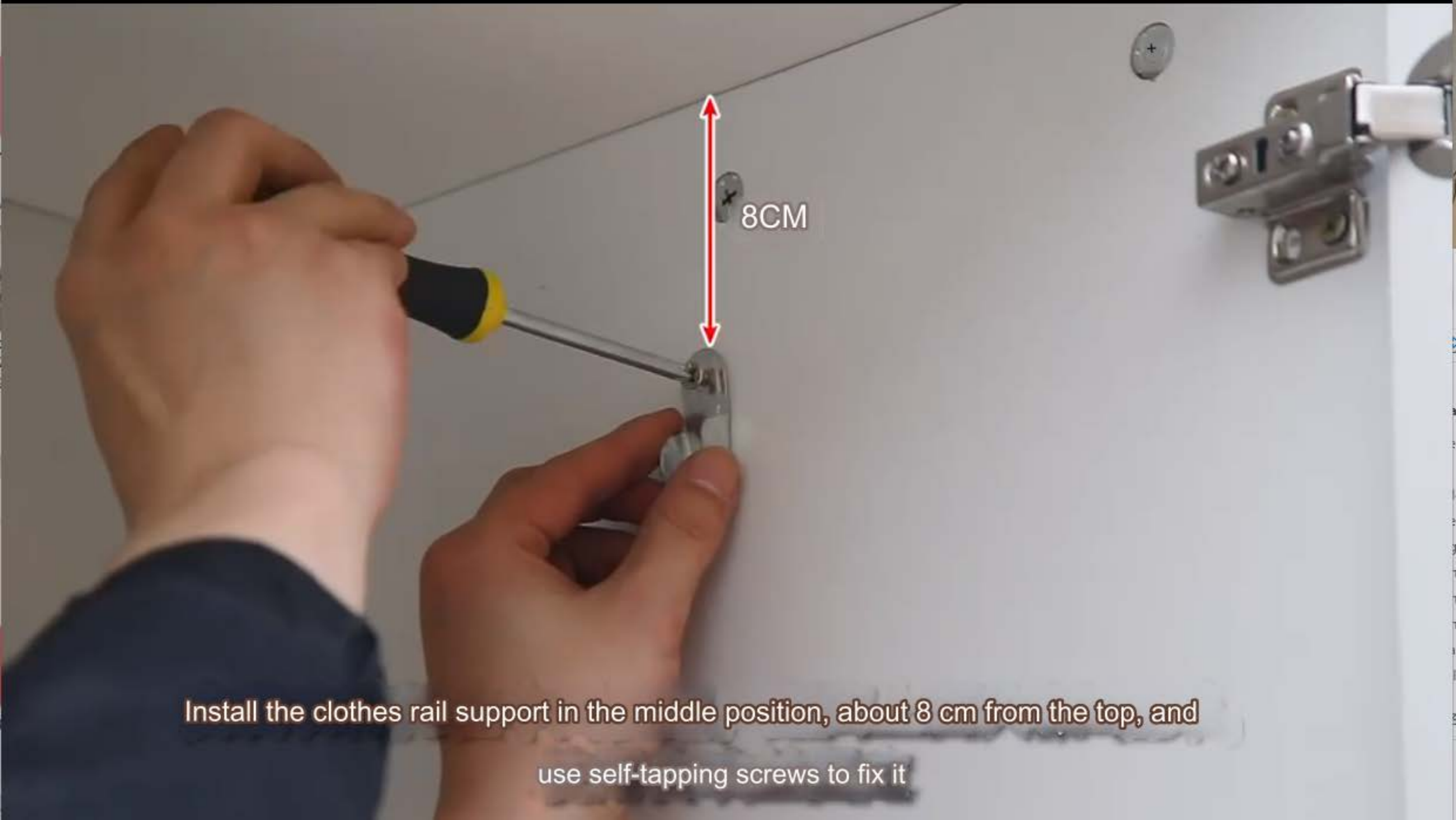

Install the clothes rail support in the middle position, about 8 cm from the top, and use self-tapping screws to fix it

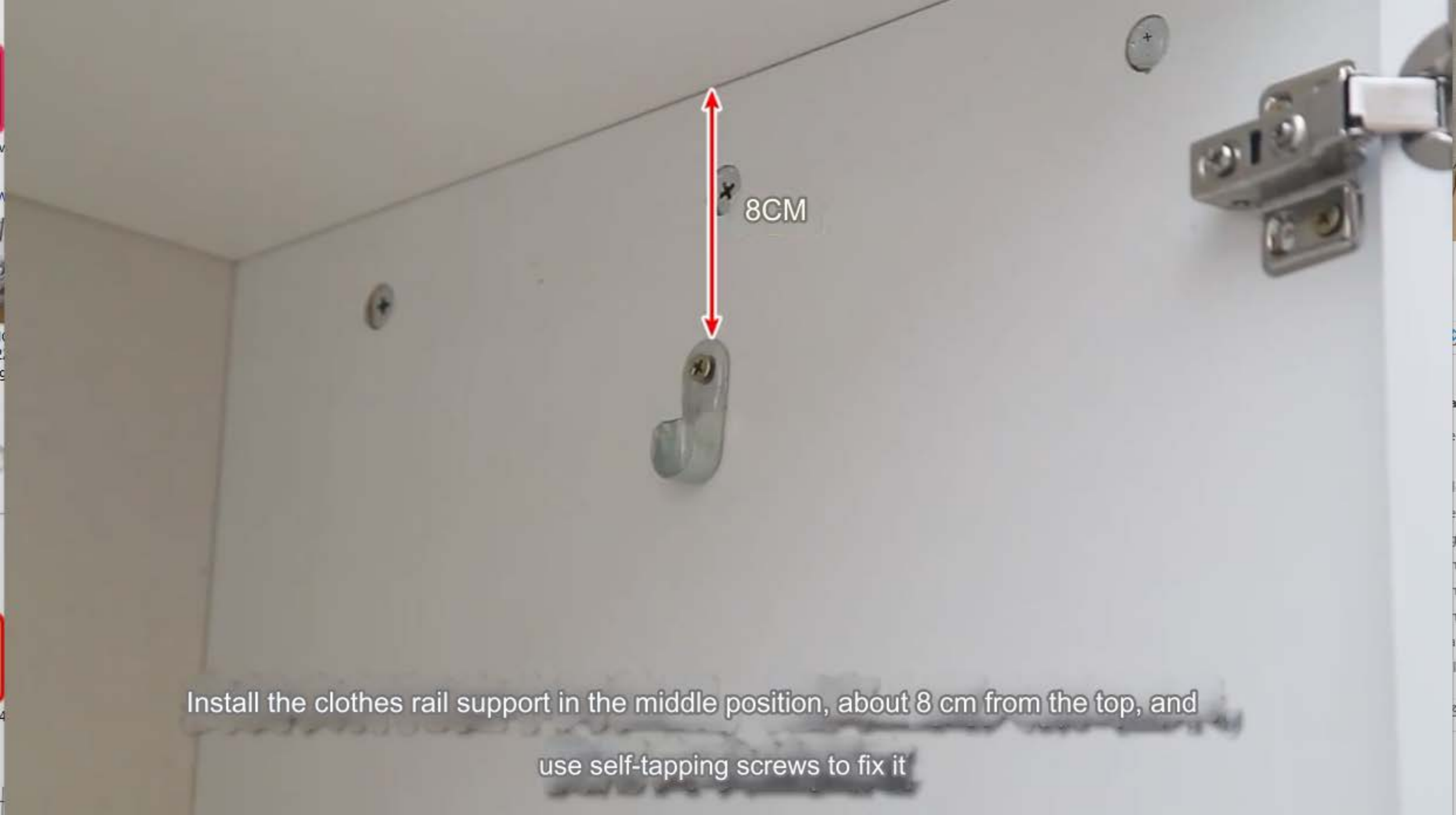

Install the clothes rail support in the middle position, about 8 cm from the top, and use self-tapping screws to fix it



Put up a clothes rail



Put up a clothes rail